

# TECHNICAL SPECIFICATIONS

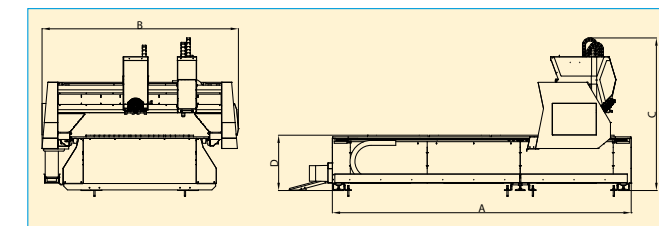

MODEL	Hypertherm model	WORK AREA			OVERALL DIMENSIONS AND WEIGHT					MAX SPEED*		MAX ACCELERATION*		ACCURACY					
		Max sheet metal length [mm]	Max sheet metal width [mm]	Standard vertical axis (Z) stroke [mm]	A Length [mm]	B Width [mm]	C Height [mm]	D Height of working bench [mm]	Approx. Weight [t]	Max speed X axis [m/min]	Max speed Y axis [m/min]	Max acceleration on X axis [m/s <sup>2</sup> ]	Max acceleration on Y axis [m/s <sup>2</sup> ]	X axis - positioning [mm]	X axis - repeatability [mm]	Y axis - positioning [mm]	Y axis - repeatability [mm]	Z axis - positioning [mm]	Z axis - repeatability [mm]
SH 1530	HPR 130 HPR260	3050	1550	200	5200	3250	2310	916	3.5	95	100	9	9	0.1	0.05	0.1	0.05	0.05	0.03
SH 2045	HPR 130 HPR260	4530	2050	200	670	3750	2310	916	4.5	95	100	9	9	0.1	0.05	0.1	0.05	0.05	0.03
SH 2060	HPR 130 HPR260	6050	2050	200	8200	3750	2310	916	5.0	95	100	9	9	0.1	0.05	0.1	0.05	0.05	0.03
SH 2080	HPR 130 HPR260	8050	2050	200	11200	3750	2310	916	6.0	95	100	9	9	0.15	0.05	0.1	0.05	0.05	0.03
SH 20120	HPR 130 HPR260	12050	2050	200	14200	3750	2310	916	7.0	95	100	9	9	0.15	0.05	0.1	0.05	0.05	0.03
SH 2545	HPR 130 HPR260	4550	2550	200	6700	4250	2310	916	5.0	95	100	9	9	0.1	0.05	0.1	0.05	0.05	0.03
SH 2560	HPR 130 HPR260	6050	2550	200	8200	4250	2310	916	5.5	95	100	9	9	0.1	0.05	0.1	0.05	0.05	0.03
SH 2580	HPR 130 HPR260	8050	2550	200	11200	4250	2310	916	6.5	95	100	9	9	0.1	0.05	0.1	0.05	0.05	0.03
SH 25120	HPR 130 HPR260	12050	2550	200	14200	4250	2310	916	8.0	95	100	9	9	0.15	0.05	0.1	0.05	0.05	0.03
SH 3060	HPR 130 HPR260	6050	3050	200	8200	4750	2310	916	9.0	95	100	9	9	0.1	0.05	0.1	0.05	0.05	0.03
SH 3080	HPR 130 HPR260	8050	3050	200	11200	4750	2310	916	10.0	95	100	9	9	0.1	0.05	0.1	0.05	0.05	0.03
SH 30120	HPR 130 HPR260	12050	3050	200	14200	4750	2310	916	11.5	95	100	9	9	0.15	0.05	0.1	0.05	0.05	0.03
SH 30150	HPR 130 HPR260	15050	3050	200	17200	4750	2310	916	13.0	95	100	9	9	0.15	0.05	0.1	0.05	0.05	0.03
SH 30180	HPR 130 HPR260	18050	3050	200	20200	4750	2310	916	14.5	95	100	9	9	0.2	0.05	0.1	0.05	0.05	0.03
SH 35120	HPR 130 HPR260	12050	3550	200	14200	5250	2310	916	15.0	95	100	9	9	0.15	0.05	0.1	0.05	0.05	0.03
SH 35150	HPR 130 HPR260	15050	3550	200	17200	5250	2310	916	16.5	95	100	9	9	0.15	0.05	0.1	0.05	0.05	0.03

\* Speed and acceleration depending on the number of heads installed

\*\* Every model can be supplied with the conventional down draft table ("F" version. Required for HPR400)